



**Schindler Smart MRL<sup>®</sup> comfort package**  
Enjoy a new level of silence, availability  
and safety





### Key figures

<b>Rated load</b>	320 / 450 / 630 / 1000 kg
<b>Speed</b>	1.0 m/s
<b>Drive type</b>	gearless with Schindler Traction Media
<b>Drive regulation</b>	variable frequency regulation with closed loop
<b>Door drive</b>	ACVF regulation

# The smart way to move up

## Experience a new level of comfort with a Schindler Smart MRL® package

Elevator technology never stands still. So it pays to invest in the future, with the Schindler Smart MRL® comfort package. It significantly improves your elevator's overall reliability and performance to secure the long-term value of your elevator and building.



### Availability & Safety

Every Schindler component undergoes vigorous testing for total reliability. That means upgrading your elevator reduces unexpected equipment outages and downtime from worn out equipment. It also ensure the availability of spare parts, when needed.



### Comfort

Schindler's new state-of-the-art drive reduces noise and vibration for a smoother ride. With accurate starting and stopping, new door technology, and noise levels reduced to below 55dB\*, you'll discover a whole new level of comfort and silence.



### Safety

All new Schindler components comply with the latest safety regulations. With a new drive, your elevator prevents uncontrolled car movement, in accordance with the latest European safety regulations. Update your elevator to today's standards.



### Minimal disruption

By reusing existing components, an upgrade of your existing elevator will have minimal impact to the environment, your building and your tenants. By planning and budgeting ahead, you minimize unexpected service interruptions and keep everyone moving smoothly through the building.

# Customise your package

## Options available to meet your needs

The basic drive, control and fixture package significantly improves your elevator's performance. To further enhance comfort, availability and energy efficiency, we recommend also installing a new door drive and LED lights.

### Basic package

#### Drive

A Schindler semi-gearless drive enables superior ride comfort and improved stopping accuracy. This compact drive requires less power due to the smaller traction sheave and the Schindler Traction Media leading to higher performance with lower energy consumption. Additionally, no oil is required.

An ACVF (variable voltage/variable frequency) closed loop regulation guarantees smooth, reliable and ecologically sound operation. And, a double disk brake offers increased safety.

- Reduced vibration and noise
- Smooth start/stop & travel
- Compliance with the latest European safety regulations, including uncontrolled car movement
- Lift institute certified

#### Digitally enabled controller

The SC controller, Schindler's latest control technology, improves the performance of your entire elevator system and prepares it for future enhancements.

- Optional extras, such as: voice annunciation, penthouse control, automatic evacuation, and door pre-opening
- Sleep mode reduces energy consumption when not in use

#### Fixtures

Sleekly designed car and landing door elements enhance the overall aesthetic and value of the building. They are also compliant with the latest European safety standards, including EN81-70, as an option.

- User friendly operation
- Timeless design in brushed stainless steel
- Landing panels with or without floor and direction indicator

### Optional enhancements

#### Door drive

A new state-of-the-art, high-performance car door drive ensures the smooth operation of the doors.

- ACVF frequency regulated door drive offers, silent operation
- Preopening doors\* for fast entry/exit
- Energy saving features, such as standby mode
- Optional EN81-20/50 compliant light curtain

#### Led light

LED lights are installed in the car. These can last up to 20 times longer than halogen lights. A bright solution for both passengers and the environment.

- Energy saving
- Highly efficient LED
- Square LED car light (1 or 2 lamps)

# Redefining style

## Improving the passenger experience

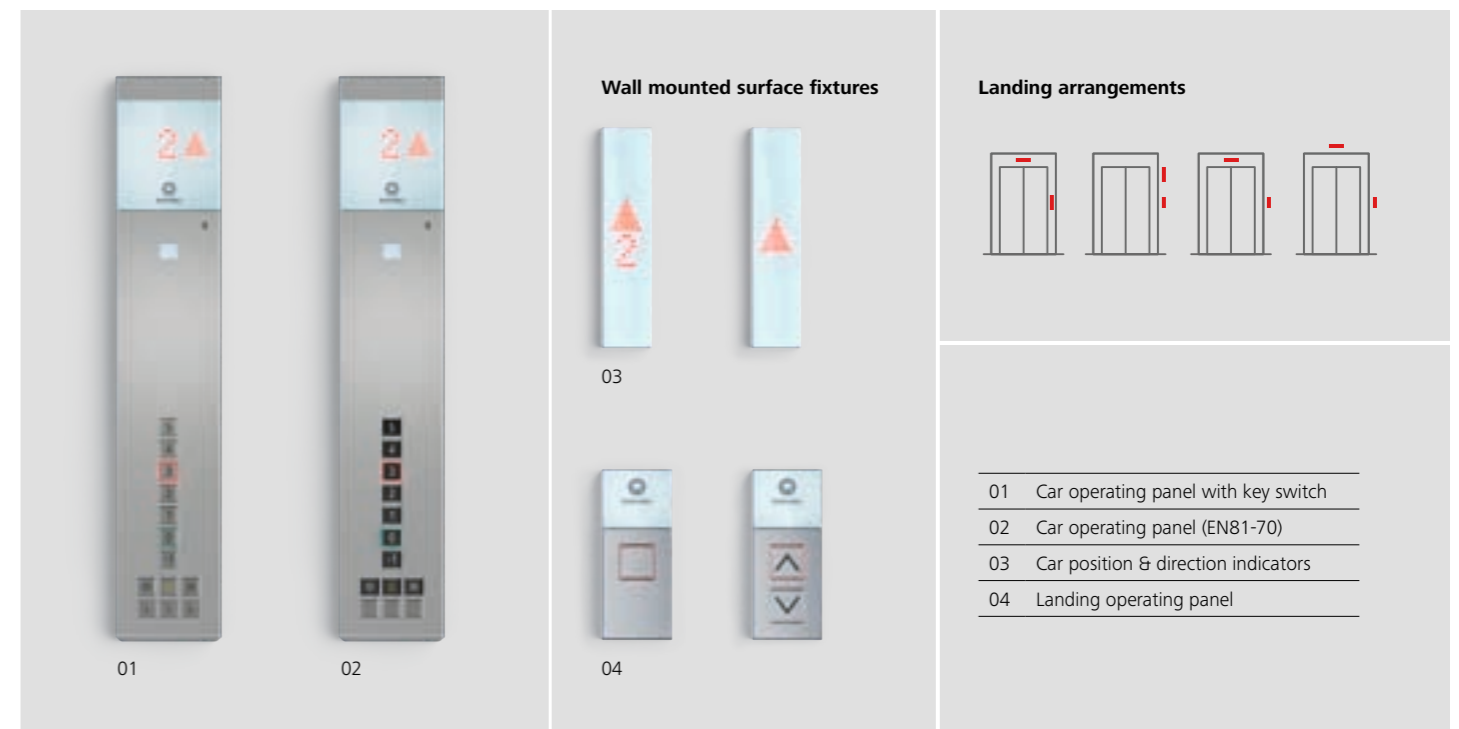



## Future-focused solutions

### Digital, energy efficient technologies

#### Driving sustainability

Green buildings play a vital role in shaping the future of construction and sustainable cities. With a smaller environmental footprint, and reduced energy and resource consumption, green buildings are one of the solutions proven to be effective in the fight against global climate change.

The components in your Schindler Smart MRL comfort package have been developed to improve the sustainability of the overall elevator system. Features such as standby mode, regenerative drive technology, and improved control functions supports the energy efficiency of your building.

#### Digitally-enabled elevator

This Schindler Smart MRL comfort package also enables the connectivity of your elevator, assuring the transition to digital services is hassle-free in the future.

With a digitally enabled elevator, you can improve the day-to-day management of your system.

By opting for a Schindler modernization package, you are also contributing to a more sustainable future. By replacing only the critical components that require an upgrade, the remaining components in the elevator can be reused and unnecessary waste is minimized.

Schindler is also considering sustainability throughout the product lifecycle, not just in the design of the components, but also in the way they are manufactured, delivered, installed, and maintained.

- Schindler Ahead ActionBoard allows your facility manager to monitor the equipment remotely.
- Adaptive maintenance service helps to recognize potential faults and provide preventative service.
- Schindler Ahead Media Services turns your elevator into an infotainment center.
- Schindler ElevateMe enables passengers to call the elevator via their mobile device.

## Installation excellence

### Working with you every step of the way

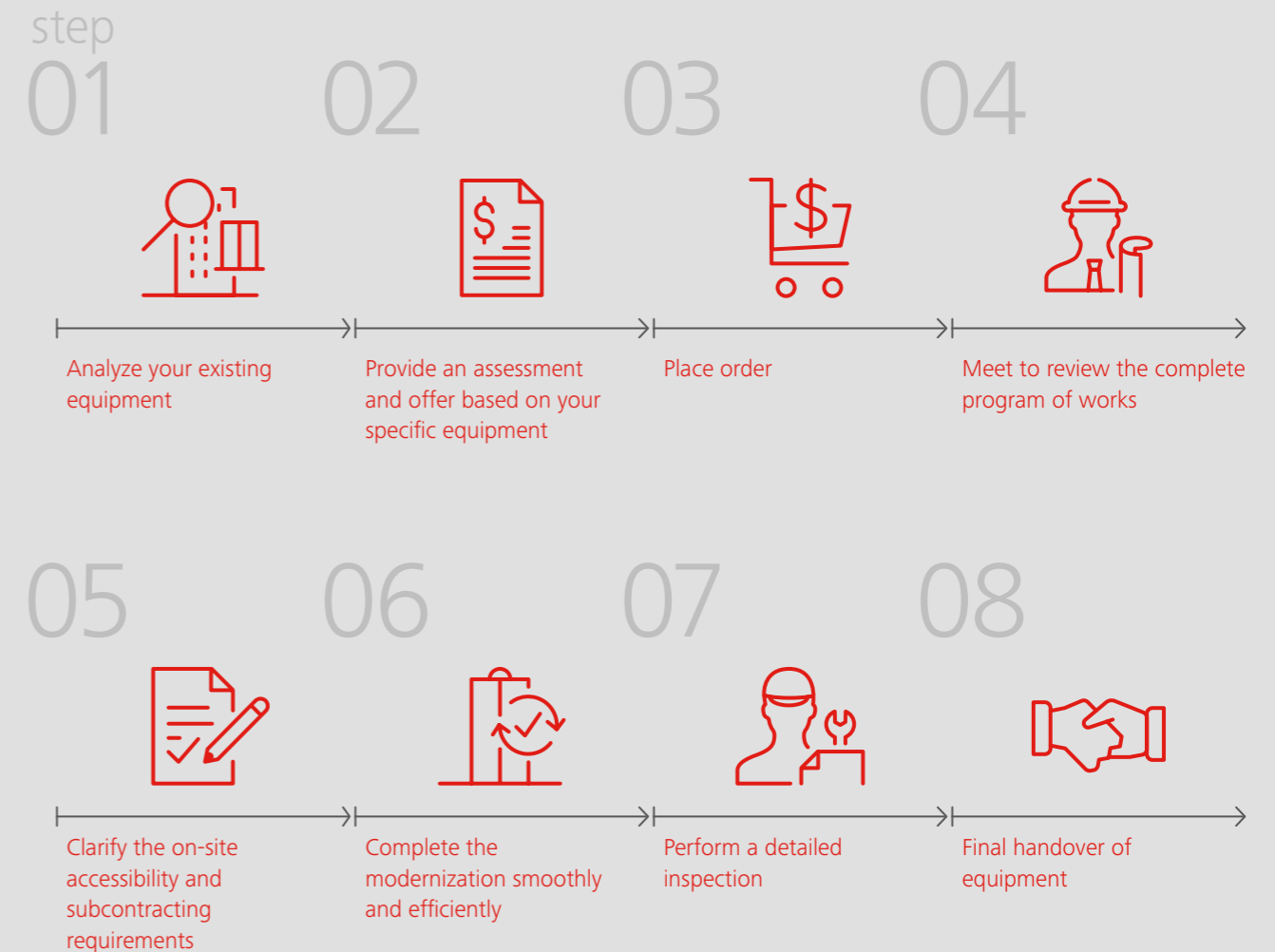

Our experience helps us to better understand and address the special requirements and the unique challenges that an elevator modernization presents. We provide high-quality consulting, support, and coordination for the successful execution of your Schindler modernization package.

To ensure a smooth installation process, we'll meet with you a few weeks before the installation date to discuss the final program of works. We will also clarify accessibility, define the storage space, and coordinate our activities with any subcontractors on-site.

Since fixtures can be installed in the same position and the landing doors can be reused, the existing layout of your elevator will not change. This minimizes the impact on the existing building infrastructure. However, our sales technicians can also assist you with the organization of building-related services (electricians, contractors, etc.), where required.

Our highly trained personnel endeavour to keep any noise, disruption or dirt caused by the installation to a minimum, always showing the utmost respect for your building and its tenants and guests. We have the expertise and experience required to manage your modernization and efficiently.



# Renew the value of your investment

## A Schindler modernization is tailored to your needs

With almost 150 years designing, manufacturing, and installing elevators, Schindler understands how to transport people and loads safely and reliably. Following a Schindler modernization, the whole elevator experience becomes smoother and more pleasant for your passengers.

Schindler modernization packages can help enhance the user experience with upgraded accessibility, aesthetics, and illumination options. They can also reduce noise, increase comfort, and improve the stopping accuracy of your elevator.

Upgrading your existing elevator not only increases reliability, safety, and performance, but also renews the value of your existing investment.

Schindler Lifts Australia Pty Ltd.  
Level 6, 241 O’Riordan Street  
Mascot NSW 2020  
Australia  
+61 2 9931 9900  
au.schindler.com

**We Elevate**



This publication is for general informational purposes only and we reserve the right at any time to alter the services, product design and specifications. No statement contained in this publication shall be construed as a warranty or condition, expressed or implied, as to any service or product, its specifications, its fitness for any particular purpose, merchantability, quality or shall be interpreted as a term or condition of any service or purchase agreement for the products or services contained in this publication. Minor differences between printed and actual colors may exist.  
Copyright © 2022 Schindler Aufzüge AG